

In Mac system, the default shortcut keys are function keys. In Windows system, the default shortcut keys are F1-F12.
When Fn lock is closed, you need to press Fn+Shortcut to achieve the shortcut function.(Press Fn+Esc to open/close Fn lock,For Win only)

	Blue light always on: Caps lock on Blue indicator light is off : Caps lock off		function key locked		Decrease brightness		Increase brightness		Multitasking window		Search
	Green light always on: NUM keypad is on Green indicator light flashing rapidly: 2.4G entering pairing mode. Green indicator light flashing slowly: 2.4G entering reconnecting mode.		Home page		Screen capture		Select all		Copy		File
	Blue light always on: Scroll lock is on Blue indicator light flashing rapidly: Bluetooth 1 entering pairing mode. Blue indicator light flashing slowly: Bluetooth 1 entering reconnecting mode.		Paste		Cut		Save		Switch input method		Emoji
	Blue light always on: FN lock open Blue indicator light flashing rapidly: Bluetooth 2 entering pairing mode. Blue indicator light flashing slowly: Bluetooth 2 entering reconnecting mode.		Previous		Play&Stop		Next		Win: dictation /Mac: siri		Lock screen
	Red light flashing rapidly: The device is low on power Red light is always on: The device is currently charging Green light is always on: Device fully charged		Mute		Volume down		Volume up		Win:Copilot / Mac:Switching Applications		

The keyboard will automatically recognize the computer system When connected to a computer; if the computer can not automatically recognize the system, please manually switch the computer system.

2.4G Mode Instructions (USB Receiver)

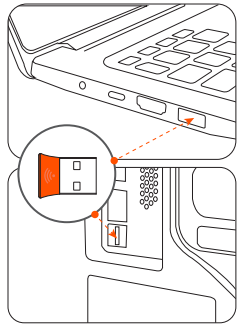

1. Insert the USB receiver into the USB port of the computer.

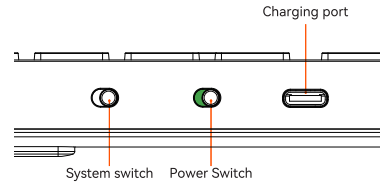

2. Press the button to move to the right to open the device.

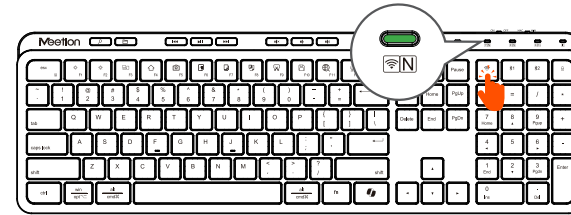

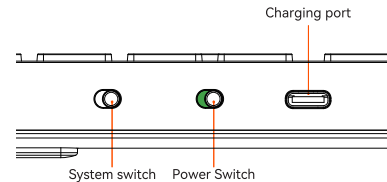

3. Click  button to switch to 2.4G mode, the corresponding 2.4G indicator light.

Bluetooth instructions

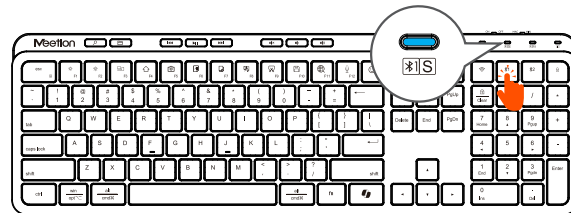

1. Press the button to move to the right to open the device.



2. Click  /  button to switch to Bluetooth 1 / Bluetooth 2 mode, the corresponding Bluetooth 1 / Bluetooth 2 indicator will light up blue and start blinking.

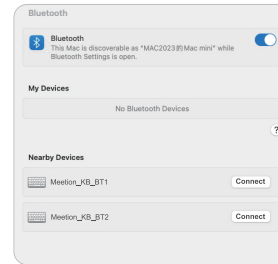

3. Find the device named "Meetion_KB_BT1" / "Meetion_KB_BT2" in your computer's Bluetooth settings and connect it, get ready!

 If you experience a keyboard malfunction, you can press and hold the 'FN + Delete' key for 5 seconds to restore the keyboard to its factory settings.

GENERAL

All MEETION brand products comply with US FCC standards (FCC ID: 2A706-MT062726), EU CE standards, CAUK standards, and Bluetooth BQB certification.

The product is manufactured in accordance with RoHS standards.

PRECAUTIONS

1. This product contains a rechargeable lithium battery.

(1) Do not dismantle, strike, crush, or expose it to fire.

(2) Stop using it immediately if severe swelling occurs.

(3) Do not place it in a high-temperature environment.

2. Do not use this device near water.

3. Only use a dry cloth to clean this product.

4. Please follow the manufacturer's instructions for use.

5. If the device is damaged, for example, if liquid enters it, if it gets wet in the rain or becomes damp, or if it cannot operate normally, it must be repaired. For repair matters, it should be entrusted to qualified maintenance personnel.

KIND TIPS

If the product is not in use for an extended period, it is recommended to charge it every three months to activate the lithium battery and prevent battery failure due to prolonged non-use.

Meetion

TECHNICAL SUPPORT

Having technical problems with this product?

Send an email to service@meetion.com

For more information please visit:

www.meetion.com