

Low Battery Indicator/Charging Indicator

Low Battery Status: When the device is low on power, the red indicator light in this position will blink on to remind you to charge the device. Charging Status: When you are charging the device, the red indicator light in this position will be on continuously, and the red indicator light will be off when the device is fully charged.

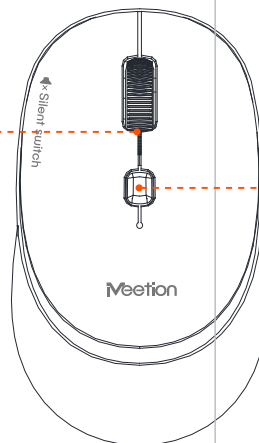

DPI Speed Switch Button

Pressing this button will switch between different mouse pointer movement speeds, ranging from slow to fast: 800/1200/1600/2400/3200 DPI. The default DPI speed is set to 1600.



Bluetooth 2 Connection Indicator

When entering the Bluetooth 2 connection mode, the blue indicator light will be flashing, at this time you can find the Bluetooth device name "MeetionMS.2" in the Bluetooth setting interface of the computer, and then you can use it normally after connecting.



Bluetooth 1 Connection Indicator

When entering the Bluetooth 1 connection mode, the blue indicator light will be flashing, at this time you can find the Bluetooth device name "MeetionMS.1" in the Bluetooth setting interface of the computer, and then you can use it normally after connecting.



2.4G Connection Indicator (USB Receiver)

When in 2.4G connection mode, the green indicator will light up. Then, you can plug the USB receiver into the computer for normal use.

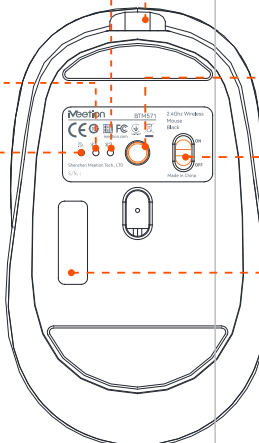

Type-c charging port

Plug the Type-C charging cable into the charging port to charge your device. We recommend connecting your computer's USB port with the included Type-C charging cable or charging it with a safety-certified charger. Charging this device with a non-compliant charger may cause it to be damaged.



Mode switching button

Click: Switch the current connection mode. (Switch order: 2.4G → Bluetooth)
Bluetooth mode: long press and hold for 3 seconds to enter pairing mode. (Note: There is no function available under the 2.4G channel.)



Power switch ON/OFF

Up and down toggle switch, This switch turns the unit on or off.



USB receiver storage bin

It is recommended to store the USB receiver in this location when the mouse is in Bluetooth mode.



2.4G Mode Instructions (USB Receiver)

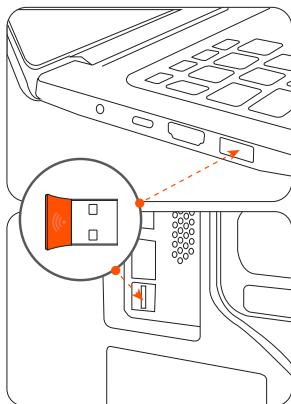

1. Insert the USB receiver into the USB port of your computer.

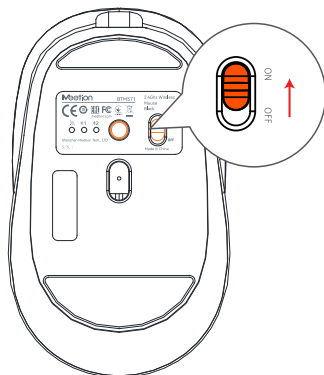

2. Toggle the switch upward to the "ON" position to turn the device on.

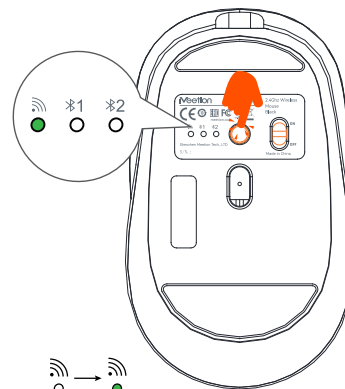

3. Click the "Mode Switching Button" to switch to 2.4G mode, the corresponding 2.4G indicator will light up green, get ready!

Bluetooth instructions

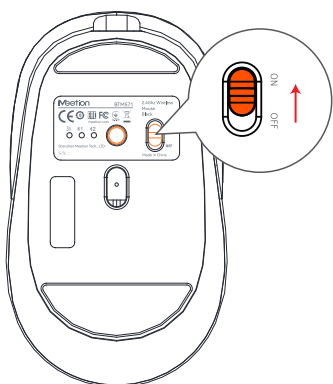

1. Toggle the switch upward to the "ON" position to turn the device on.

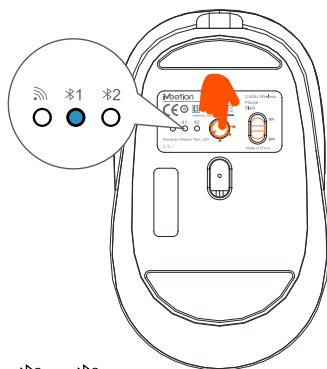

*1 → *1 *2 → *2

2. Click the "Mode Switching Button" to switch to Bluetooth mode, the corresponding Bluetooth indicator will light up blue and start blinking.

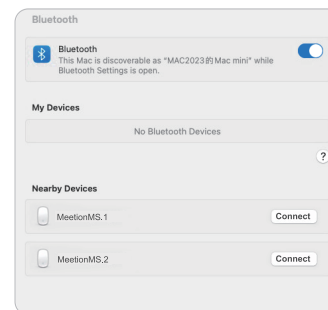

3. Find the device named "MeestionMS.1" / "MeestionMS.2" in your computer's Bluetooth settings and connect it, get ready!

GENERAL

All MEETION brand products comply with US FCC standards (FCC ID: 2A7O6), EU CE standards/CAUK standards, Bluetooth BQB certification.

The product is made in accordance with RoHS standard.

PRECAUTIONS

1. This product contains a rechargeable lithium battery.

(1) Do not dismantle, strike, crush, or put it into a fire.

(2) Stop using it immediately if severe swelling occurs.

(3) Do not place it in a high-temperature environment.

2. Do not use this device near water.

3. Only use a dry cloth to clean this product.

4. Please follow the manufacturer's instructions for use.

5. If the device is damaged, for example, if liquid enters it, if it gets wet in the rain or becomes damp, or if it cannot operate normally, it must be repaired. For repair matters, it should be entrusted to qualified maintenance personnel.

KIND TIPS

If the product is not in use for a long time, it is recommended to charge it every three months to activate the lithium battery inside the product and prevent battery failure due to long periods of non-use.

Meestion

TECHNICAL SUPPORT

Having technical problems with this product?

Send an email to service@meestion.com

For more information please visit:

www.meestion.com