

Battery compartment
AA battery compartment

Power switch ON/OFF
Toggle the switch up and down to switch the device on and off

USB receiver
USB receiver for mouse in 2.4G connection mode
(We recommend storing the USB receiver in this location when not in use)

Right turn wheel
Click (scroll wheel to the right): Scroll the page horizontally to the right.

Left turn wheel
Click (scroll wheel to the left): Scroll the page horizontally to the left.

DPI Speed Switch Button
Pressing this button will switch to different mouse pointmovement speeds, from slow to fast: 800/1200/1600/2400.

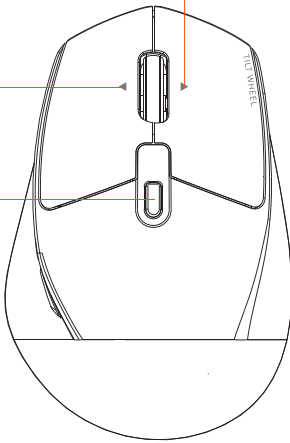

Backward
Click:backward.

Forward
Click:forward.

Low Battery Indicator
Low battery alert: When the device is low on power, the red indicator light at this location will blink, reminding you to replace the battery.

2.4G Connection Indicator (USB Receiver)
When entering the 2.4G connection mode, the green indicator at this position will light up, at this time you can plug the USB receiver into the computer for normal use.

Mode switching button
Click: Switch current connection mode.
(Switch order: 2.4G->Bluetooth 1->Bluetooth 2)
Long press: Press and hold for 3 seconds to enter pairing mode. (There is no function under the 2.4G channel.).

Bluetooth 2 Connection Indicator
When entering the Bluetooth 2 connection mode,the blue indicator light will be flashing,at this time you can find the Bluetooth device name"Meet-ion_MS_BT2"in the Bluetooth setting interface of the computer,and then you can use it normally after connecting.

Bluetooth 1 Connection Indicator
When entering the Bluetooth 1 connection mode,the blue indicator light will be flashing,at this time you can find the Bluetooth device name"Meet-ion_MS_BT1"in the Bluetooth setting interface of the computer,and then you can use it normally after connecting.

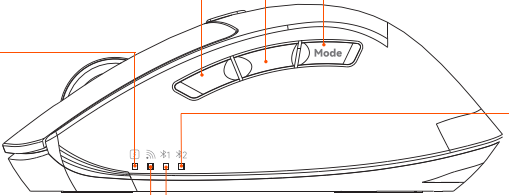

! In Mac system, the default shortcut keys are function keys.
In Windows system, the default shortcut keys are F1-F12.

	The red light illuminates for 3 seconds: the keyboard is turning on The red light flashing quickly: the keyboard needs to be charged.		FN Lock		Brightness+		Brightness-
	Green light steady: Turn on the Num Lock. Blue light on for 2 seconds: connected to 2.4G mode. Blue light flashing quickly: entering pairing mode.		Multitasking		Desktop		Computer
	Green light steady: Turn on the Caps Lock. Blue light on for 2 seconds: connected to Bluetooth 1 mode. Blue light flashing quickly: entering pairing mode.		Search		Previous		Play/Pause
	Green light steady: Turn on the FN Lock. Blue light on for 2 seconds: connected to Bluetooth 2 mode. Blue light flashing quickly: entering pairing mode.		Next		Muted		Volume-
			Volume+				

! The keyboard will automatically recognize the computer system when the receiver is plugged into the computer; if the computer can not automatically recognize the system, please manually switch the computer system.

Preparation before starting the connection:

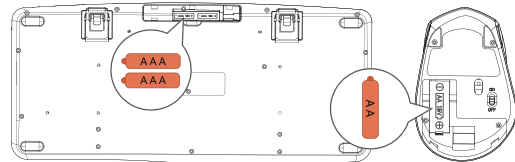

1.Install the batteries into the keyboard and mouse battery compartments .

! batteries not included, need to be prepared by yourself.



2. Move the switch to the left to the "ON" position to turn on the device.

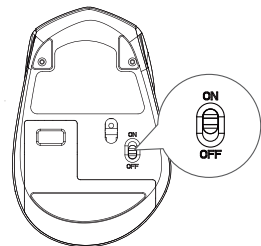

3. Toggle the switch upward to the “ON” position to thrn the device on.

Keyboard

How to reconnect Bluetooth?

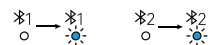

If you want to reconnect your Bluetooth keyboard, please click *1 / *2 button to switch to "Bluetooth 1"/"Bluetooth 2" mode, and then long press *1 / *2 button again to make the blue light blinking, and then you can connect it in the Bluetooth settings!

2.4G Mode Instructions (USB Receiver)

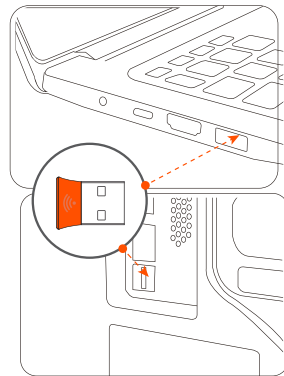

1. Insert the USB receiver into the USB port of your computer.

! Keyboard and mouse share a common USB receiver

Bluetooth instructions



1. Click *1 / *2 button to switch to Bluetooth 1 / Bluetooth 2 mode, the corresponding Bluetooth 1 / Bluetooth 2 indicator will light up blue and start blinking.

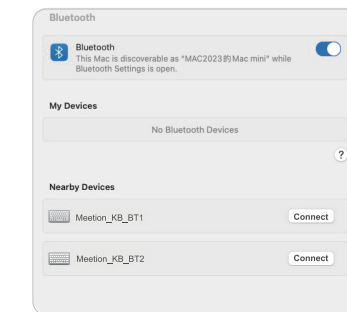

2. Find the device named "Meetion_K-B_BT1" / "Meetion_KB_BT " in your computer's Bluetooth settings and connect it,get ready!

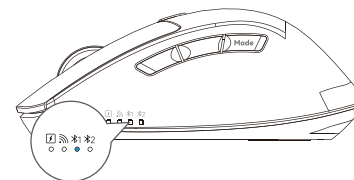

1. Click the "Mode Switching Button" to switch to Bluetooth 1 / Bluetooth 2 mode, the corresponding Bluetooth 1 / Bluetooth 2 indicator will light up blue and start blinking.

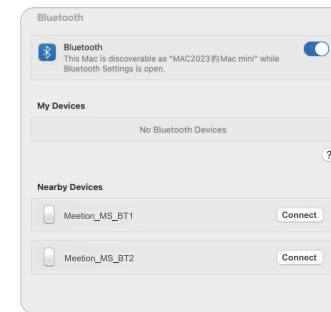

2. Find the device named "Meetion_MS_BT1" / "Meetion_MS_BT2" in your computer's Bluetooth settings and connect it,get ready!

Mouse

How to reconnect Bluetooth?

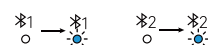

If you want to reconnect your Bluetooth Mouse, please click the "Mode Switching Button" to switch to "Bluetooth 1"/"Bluetooth 2" mode, then long press the "Mode Switching Button" so that the blue light blinks, and then connect to it in the Bluetooth settings! Then connect in the Bluetooth settings!

GENERAL

All MEETION brand products comply with US FCC standards (FCC ID: 2A706), EU CE standards/CAUK standards, Bluetooth BQB certification.

The product is made in accordance with RoHS standard.

PRECAUTIONS

1.Safety precautions for product use:

(1)Do not dismantle,strike,crush,or put it into a fire.

(2)Stop using it immediately if severe swelling occurs.

(3)Do not place it in a high-temperature environment.

2.Do not use this device near water.

3.Only use a dry cloth to clean this product.

4.Please follow the manufacturer's instructions for use.

5.If the device is damaged,for example,if liquid enters it,if it gets wet in the rain or becomes damp,or if it cannot operate normally,it must be repaired.For repair matters,it should be entrusted to qualified maintenance personnel.

KIND TIPS

If the product is not in use for a long time,it is recommended to charge it every three months to activate the lithium battery inside the product and prevent battery failure due to long periods of non-use.

Meetion

TECHNICAL SUPPORT

Having technical problems with this product?
Send an email to service@meetion.com
For more information please visit:
www.meetion.com